

# XT232A1FAL2

capacitive sensor - XT1 - cylindrical Ø 32 mm -  
plastic - Sn 20 mm - cable 2 m



## Main

|                                    |  |
|------------------------------------|--|
| Range of product                   | OsiSense XT                                    |
| Sensor type                        | Capacitive proximity sensor                    |
| Product specific application       | Detection of insulated or conductive materials |
| Sensor name                        | XT2  |
| Sensor design                      | Cylindrical Ø 32 mm plain                      |
| Size                               | 80 mm  |
| Body type                          | Fixed  |
| Detector flush mounting acceptance | Non flush mountable                            |
| Material                           | Plastic  |
| Enclosure material                 | Plastic  |
| Type of output signal              | Discrete                                       |
| Wiring technique                   | 2-wire   |
| [Sn] nominal sensing distance      | 20 mm  |
| Discrete output function           | 1 NO   |
| Output circuit type                | AC   |
| Electrical connection              | Cable  |
| Cable length                       | 6.56 ft (2 m)                                  |
| [Us] rated supply voltage          | 24...240 V AC 50...60 Hz<br>24 V DC            |
| Maximum delay response             | 30 ms  |
| IP degree of protection            | IP67 double insulation IEC 60529               |

## Complementary

|                                 |                                       |
|---------------------------------|---------------------------------------|
| Detection face                  | Frontal                               |
| [Sa] assured operating distance | 0.00...0.59 in (0...15 mm)            |
| Adjustment zone                 | 0.00...0.87 in (0...22 mm)            |
| Differential travel             | < 1...20 % Sr                         |
| Repeat accuracy                 | < 5 % Sr                              |
| Wire insulation material        | PVC                                   |
| Status LED                      | Output state indication 1 LED yellow) |

|                           |                              |
|---------------------------|------------------------------|
| Supply voltage limits     | 20...265 V AC                |
| Switching frequency       | <= 15 Hz                     |
| Maximum voltage drop      | <10 V closed)                |
| Current consumption       | < 4 mA                       |
| Maximum delay first up    | 200 ms                       |
| Maximum delay recovery    | 30 ms                        |
| Maximum switching current | 300 mA                       |
| Marking                   | CE                           |
| Setting-up                | Sensitivity by potentiometer |
| Length                    | 3.15 in (80 mm)              |
| Net weight                | 0.88 lb(US) (0.4 kg)         |

## Environment

|                                       |  |
|---------------------------------------|--|
| Standards                             | EN/IEC 60947-5-2                                     |
| Product certifications                | CULus  |
| Ambient air temperature for operation | 14...140 °F (-10...60 °C)                            |
| Vibration resistance                  | 10 gn 1 mm 10...55 Hz)IEC 60068-2-6                  |
| Shock resistance                      | 30 gn 11 ms IEC 60068-2-27                           |
| Resistance to electrostatic discharge | 4 kV contact IEC 61000-4-2<br>8 kV air IEC 61000-4-2 |
| Resistance to electromagnetic fields  | 2.74 V/yd (3 V/m) IEC 61000-4-3                      |
| Resistance to fast transients         | 2 kV conforming to IEC 61000-4-4                     |

## Packing Units

|                  |                        |
|------------------|------------------------|
| Package 1 Weight | 0.46 lb(US) (0.208 kg) |
| Package 1 Height | 0.400 dm               |
| Package 1 width  | 1.300 dm               |
| Package 1 Length | 1.400 dm               |

## Offer Sustainability

|                            |   |
|----------------------------|---|
| REACH Regulation           | <a href="#">REACH Declaration</a>   |
| REACH free of SVHC         | Yes   |
| EU RoHS Directive          | Pro-active compliance (Product out of EU RoHS legal scope)<br><a href="#">EU RoHS Declaration</a> |
| Toxic heavy metal free     | Yes   |
| Mercury free               | Yes   |
| RoHS exemption information | <a href="#">Yes</a>   |

## Contractual warranty

|          |           |
|----------|-----------|
| Warranty | 18 months |
|----------|-----------|

## Dimensions

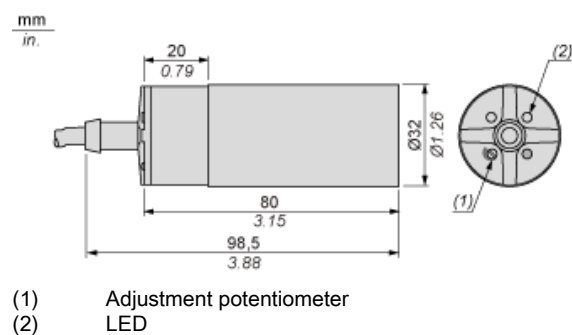

## Mounting Accessory Included

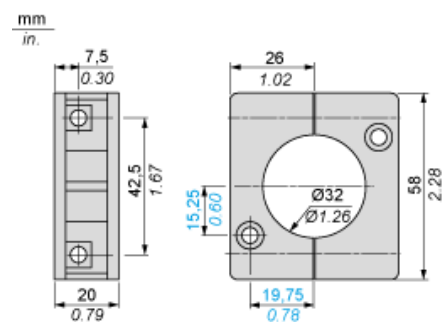

## Setting-up

### Minimum Mounting Distances (mm)

Side by side

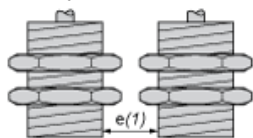

$$e(1) \geq 65$$

Face to face

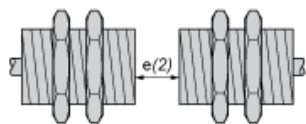

$$e(2) \geq 120$$

Facing a metal object

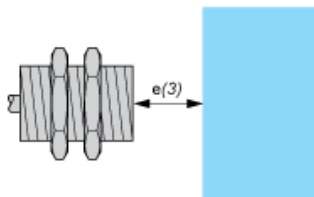

$$e(3) \geq 60$$

Mounted in support

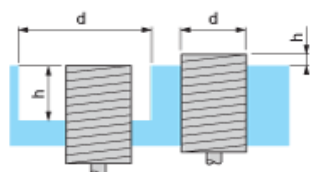

$$d \geq 100$$

$$h \geq 30$$

---

## Adjustment

---

### Sensitivity Adjustment

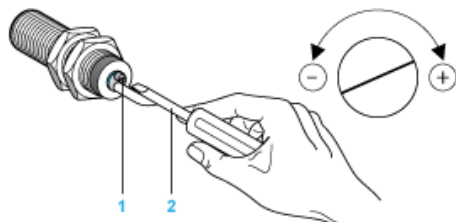

- (1) Adjustment potentiometer
- (2) Screwdriver (included with sensor)

Wiring Diagram

Pre-cabled

2-wire AC NO Output

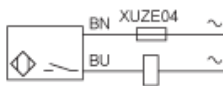

(BU) Blue  
(BN) Brown