

# Channel Cable Tray - Accessories

## Splice Plate

The Splice Plate has the standard 4-hole pattern for all cable channel.

- Provided with straight sections and fittings.
- Furnished as one plate with hardware.
- (\*) Insert **A** **G** **P** **SS4** **SS6**

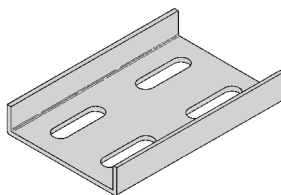

Catalog No.	Channel Width	
	in.	(mm)
9(*)-1043	3	(76)
9(*)-1044	4	(101)
9(*)-1044-6	6	(152)

## Horizontal Adjustable Splice Plate

The Horizontal Adjustable Splice Plate adapts to changes in direction in a horizontal plane, beyond the capability of the standard horizontal fittings.

- Furnished as one plate with hardware.
- (\*) Insert **A** **G** **P** **SS4** **SS6**

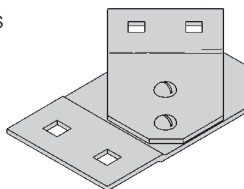

Requires supports within 24" on both sides, per NEMA VE 2.

Catalog No.	Channel Width	
	in.	(mm)
9(*)-1743	3	(76)
9(*)-1744	4	(101)
9(*)-1746	6	(152)

## Box Connector

The Box Connector is used to attach the end of a cable channel run to a distribution box or a control center.

- Furnished as one connector with hardware.
- (\*) Insert **A** **G** **P** **SS4** **SS6**

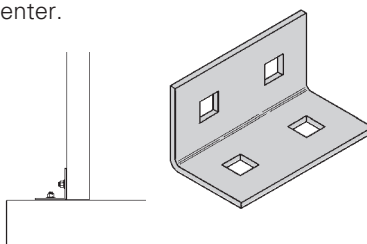

Catalog No.	Channel Width	
	in.	(mm)
9(*)-1543	3	(76)
9(*)-1544	4	(101)
9(*)-1546	6	(152)

## Channel Reducer Plate

The Channel Reducer Plate is used to join cable channel sections of different widths.

- Furnished as one plate with hardware.
- (\*) Insert **A** **G** **P** **SS4** **SS6**

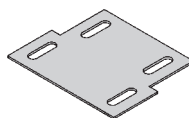

Catalog No.	Channel Width	
	in.	(mm)
9(*)-1843	4 to 3	(101 to 76)
9(*)-1863	6 to 3	(152 to 76)
9(*)-1864	6 to 4	(152 to 101)

## Blind End Plate

The Blind End Plate forms a closure for any cable channel dead end.

- Furnished as one plate with hardware.
- (\*) Insert **A** **G** **P** **SS4** **SS6**

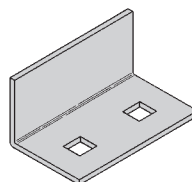

Catalog No.	Channel Width	
	in.	(mm)
9(*)-1583	3	(76)
9(*)-1584	4	(101)
9(*)-1586	6	(152)

● Green = Fastest shipped items    ● Black = Normal lead-time items    ● Red = Normally long lead-time items

All dimensions in shaded areas are millimeters unless otherwise specified.

## Vertical Adjustable Splice Plate

The Adjustable Splice Plate allows changes in elevation where standard vertical fittings are not applicable.

- Furnished as one plate with hardware.
- (\*) Insert **A** **G** **P** **SS4** **SS6**

Requires supports within 24" on both sides, per NEMA VE 2.

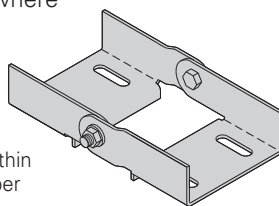

Catalog No.	Channel Width	
	in.	(mm)
9(*)-1643	3	(76)
9(*)-1644	4	(101)
9(*)-1646	6	(152)

## Channel To Tray or Channel To Channel Connector

The Channel Connector is used to link a cable channel to a cable tray, or a cable channel to cable channel.

- Furnished as one plate with hardware.
- (\*) Insert **A** **G** **P** **SS4** **SS6**

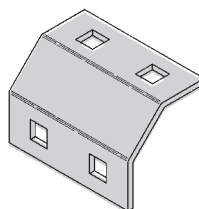
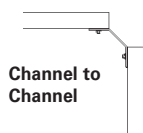

Catalog No.	Channel Width	
	in.	(mm)
9(*)-1261-3	3	(76)
9(*)-1261-4	4	(101)
9(*)-1261-6	6	(152)

## Mounting Bracket - Channel To Tray

The Mounting Bracket allows a parallel run of cable channel to be attached to the side of a cable tray. It can also serve as a support splice connection.

- Furnished as one bracket.
- Order hardware separately.
- (\*) Insert **A** **G** **ZN** **SS4** **SS6**

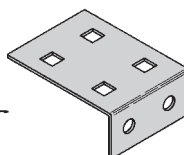

Catalog No.	Channel Width	
	in.	(mm)
9(*)-1237-3	3	(76)
9(*)-1237-4	4	(101)
9(*)-1237-6	6	(152)

## Expansion Guide Clamp

The Expansion Guide Clamp allows cable channel to expand and contract in the horizontal plane, but not in the transverse plane.

- Furnished as one clamp.
- Order 1/2" hardware separately.
- (\*) Insert **A** **G** **ZN** **SS4** **SS6**

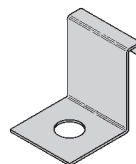

Catalog No.	Channel Width	
	in.	(mm)
9(*)-1243	3	(76)
9(*)-1244	4	(101)
9(*)-1244	6	(152)

## Hold-Down Clamp

The Hold-Down Clamp secures cable channel to a support member.

- Furnished as one clamp.
- Order 1/2" hardware separately.
- (\*) Insert **A** **G** **ZN** **SS4** **SS6**

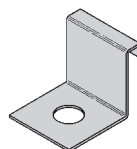

Catalog No.	Channel Width	
	in.	(mm)
9(*)-1245	3	(76)
9(*)-1246	4	(101)
9(*)-1246	6	(152)

● Green = Fastest shipped items    ● Black = Normal lead-time items    ● Red = Normally long lead-time items

All dimensions in shaded areas are millimeters unless otherwise specified.

# Channel Cable Tray - Accessories

## Channel To Floor Base Plate

The Channel to Floor Base Plate is used to attach the end of a cable channel run to the floor or to an equipment mounting pad.

- Anchors and hardware are ordered separately.
- (\*) Insert **A** **G** **ZN** **SS4** **SS6**

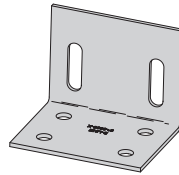

Catalog No.	Channel Width	
	in.	(mm)
<b>9(*)-3305-3</b>	3	(76)
<b>9(*)-3305-4</b>	4	(101)
<b>9(*)-3305-6</b>	6	(152)

## Cable Channel Bushing

The Cable Channel Bushing is a snap-in plastic bushing used to protect cable insulation from mechanical wear.

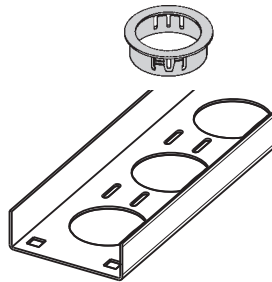

Catalog No.
<b>99-1125</b>

## Cable Channel Bracket

- Uniform Load: 225 lbs (1.00 kN) Safety Factor of 2.5
- Finishes available: **ZN** **G**

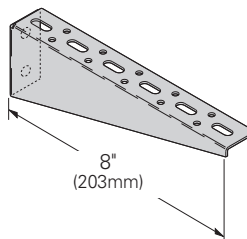

Catalog No.	Channel Width	
	in.	(mm)
<b>B185CCL</b>	3 to 6	(76 to 152)

## Cable Channel Bracket

- Safety Factor of 2.5
- Finishes available: **ZN** **G** **GRN**

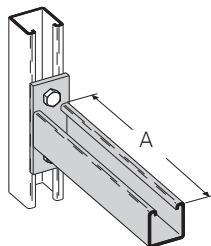

Catalog No.	Channel Width		Uniform Load		A	
	in.	(mm)	lbs	(kN)	in.	(mm)
<b>B409-6</b>	3	(76)	1920	(8.54)	6	(152)
<b>B409-9</b>	4, 6	(101, 152)	1280	(5.69)	9	(228)

## Cable Channel Hanger

Designed for 1/2" threaded rod, double nut installation

Single Cable Channel Hanger and Wall Mount

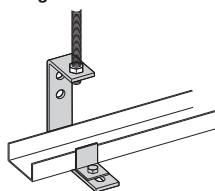

150 lb.  
Safety Factor 3.0

Material	Channel Width		
	in. (mm)	in. (mm)	in. (mm)
	3 (76)	4 (101)	6 (152)
<b>Zinc Plated Steel</b>			
Double Channel	● <b>9ZN-1232-3</b>	● <b>9ZN-1232-4</b>	● <b>9ZN-1232-6</b>
Single Channel	● <b>9ZN-1231-3 &amp; 4</b>	● <b>9ZN-1231-3 &amp; 4</b>	● <b>9ZN-1231-6</b>
<b>HDGAF Steel (18 Ga.)</b>			
Double Channel	● <b>9G-1232-3</b>	● <b>9G-1232-4</b>	● <b>9G-1232-6</b>
Single Channel	● <b>9G-1231-3 &amp; 4</b>	● <b>9G-1231-3 &amp; 4</b>	● <b>9G-1231-6</b>

Double Cable Channel Hanger

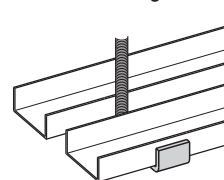

265 lb.  
Safety Factor 3.0

● Green = Fastest shipped items    ● Black = Normal lead-time items    ● Red = Normally long lead-time items

All dimensions in shaded areas are millimeters unless otherwise specified.

## Cable Channel Covers

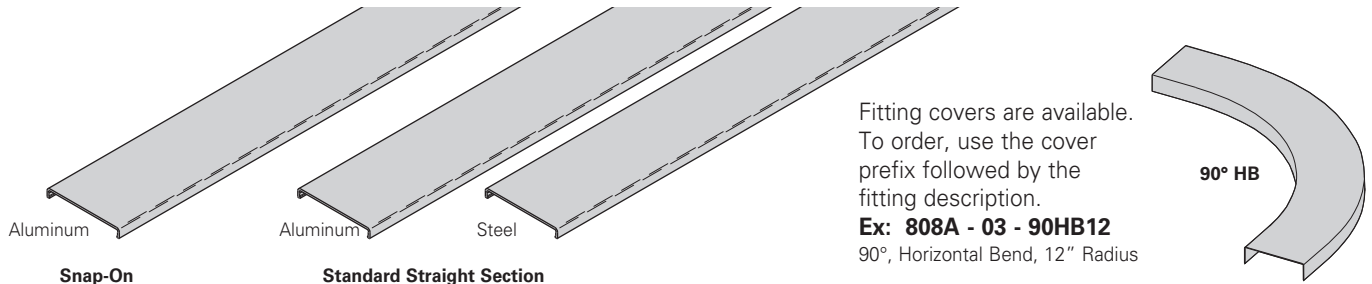

### Covers Part Numbering

Prefix  
 Example: **80 8 S A - 04 - 144**

#### Cover Type

80 = Solid

#### Detail

8 = Flanged

#### Style

S = Snap-On  
 (Aluminum only\*)  
 \_\_ = Standard

#### Material

● A = Aluminum  
 ● G = Type 1 HDGAF  
 ● P = Type 2 Pre-Galvanized  
 ● SS4 = 304 Stainless Steel  
 ● SS6 = 316 Stainless Steel

#### Tray Width

● 03 = 3"  
 ● 04 = 4"  
 ● 06 = 6"

#### Item Description

##### For Straight Section Cover:

Pre-Galv & Aluminum Only:  
 144 = 12 ft.  
 120 = 10 ft.  
 Pre-Galv, HDGAF & Alum  
 72 = 6 ft.\*  
 60 = 5 ft.\*

Insert suffix of fitting to be covered from the fitting's page.

\_\_HB\_\_ = Horizontal Bend  
 HT\_\_ = Horizontal Tee  
 HX\_\_ = Horizontal Cross  
 \_\_VI\_\_ = Vertical Inside Bend  
 \_\_VO\_\_ = Vertical Outside Bend

All items normal lead time except for those indicated

Material	Length		Channel Width - Straight Section Part Number		
	ft	(m)	in. (mm)	in. (mm)	in. (mm)
● Aluminum (.032) ● Solid	12	3.56m	808A-03-144	808A-04-144	808A-06-144
	10	3.05m	808A-03-120	808A-04-120	808A-06-120
● Type II Pre-Galvanized Steel (20 Ga.) ● Solid	12	3.56m	808P-03-144	808P-04-144	808P-06-144
	10	3.05m	808P-03-120	808P-04-120	808P-06-120
● Type I Hot Dip Galvanized Steel (18 Ga.) ● Solid	12	3.56m	808G-03-72	808G-04-72	808G-06-72
	10	3.05m	808G-03-60	808G-04-60	808G-06-60

### Wrap-Around Cover Clamp

Wrap-Around Cover Clamps are used to securely hold a cover on cable channel in locations where strong winds can prevail.

- Furnished as one clamp with hardware.
- (\*) Insert **A G P SS4 SS6**

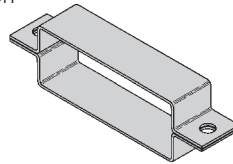

Catalog No.	Channel Width	
	in.	(mm)
9(*)-9033	3	(76)
9(*)-9034	4	(101)
9(*)-9036	6	(152)

### Combination Hold-Down & Cover Clamp

This clamp is used to hold both the cable channel and cover in place at the same time.

- Furnished as one clamp.
- Order 1/4" hardware separately.
- (\*) Insert **A G P SS6**

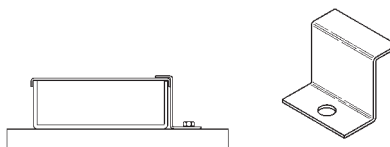

Catalog No.	Channel Width	
	in.	(mm)
9(*)-9023	3	(76)
9(*)-9024	4	(101)
9(*)-9024	6	(152)

● Green = Fastest shipped items ● Black = Normal lead-time items ● Red = Normally long lead-time items

All dimensions in shaded areas are millimeters unless otherwise specified.

# Channel Cable Tray - Accessories

## Channel Cable Tray Connectors

Fast, economical, space saving Channel Cable Tray Connectors  
Patent No. 5,628,481; 5,782,439. Other patents pending.

### Horizontal:

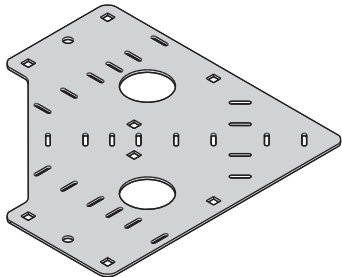

90° Bend

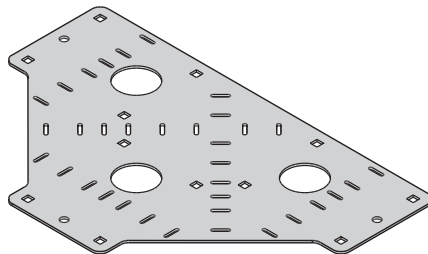

Tee

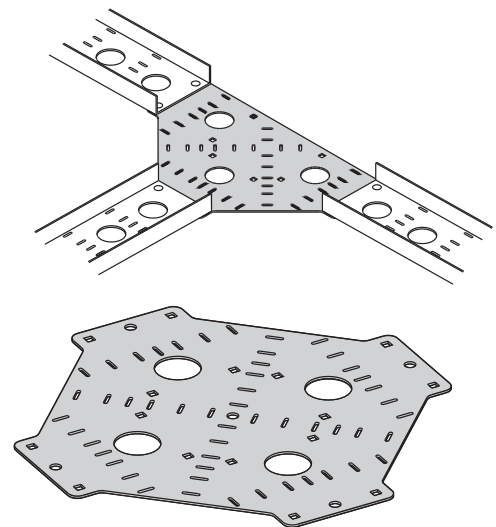

Cross

- Provides 0 or 6-inch radius connection for Cable Channel
- The Pivot Connector is available for custom angle adjustment
  - up to  $\pm 45^\circ$  angle adjustment
  - order the desired quantity separately
- Slotted for easy cable fastening
- Shipped with the required hardware

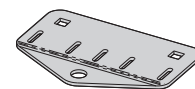

Pivot  
Connector

### Vertical:

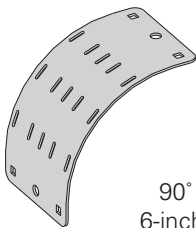

90° Bend  
6-inch radius

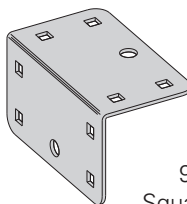

90° Vertical  
Square Connector  
0-inch radius

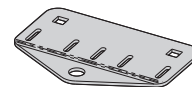

Pivot  
Connector

- Use the same part for VO and VI applications
- Slotted for easy cable fastening
- The Pivot Connector is available for custom angle adjustment (order separately)
- Shipped with the required hardware

## Connector Part Numbering

Example: <sup>Prefix</sup> **A CC - 04 - 90HC 060**

### Material

- A = Aluminum
- G = Type 1 HDGAF

### Tray Type

CC = Ventilated  
Cable Channel

### Width

- 03 = 3"
- 04 = 4"
- 06 = 6"

### Connector Type

- 90HC = 90° Horizontal
- HTC = Horizontal Tee
- HXC = Horizontal Cross
- 90VC = 90° Vertical
- PC = Pivot Connector

### Radius

Horizontal Connectors  
060 = 0" & 6" Radii  
Vertical Connectors  
00 = 0" Radius  
06 = 6" Radius

**All items normal lead time  
except for those indicated**

● Green = Fastest shipped items    ● Black = Normal lead-time items    ● Red = Normally long lead-time items

All dimensions in shaded areas are millimeters unless otherwise specified.