

Fan & Fixture Mounting Boxes

Boxes accommodate 1/2" or 5/8" drywall with 3/4" furring strips or hat channel.



FB412

FB423

Note: Install fan or fixture (not included) in accordance with manufacturer's instructions and all local applicable electrical codes, using the parked screws provided.

CATALOG NUMBER	UPC/DCI/NAED MFG #018997	DESCRIPTION / STYLE	UNIT PKG	STD PKG	DIM A	DIM B	DIM C
FB412	72189	Pan Box 14.4 Cu. In.	25	25	3.000	1.250	4.250
FB423	72190	Press-On Box 19.5 Cu. In.	25	25	3.000	1.250	4.250

Refer to chart on page R-18 for load ratings and number of single conductors.

PATENTED.



Each fan/fixture box includes...

A ready-to-tighten center screw, installed NM cable connector, mud cover, second KO, and two screws for fan/fixture bracket installation (screwed in place until removed by installer).

FEATURES AND BENEFITS

- No loose parts to misplace – totally self-contained!
- For use with 1/2" or 5/8" drywall with 3/4" furring strips or hat channel
- Also for double 5/8" drywall
- Attaches securely to joist through shipped-in-place center screw
- UL rated: 70 lb. fan; 200 lb. fixture;
CSA rated: 50 lb. fan/fixture

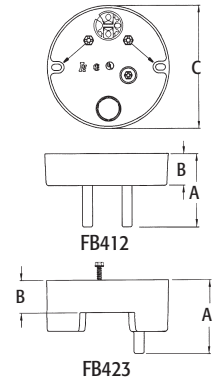

FB412

FB423



FB412