

Ordering information

Part number example

V65H-G-JM5-T57

-V-Spring telescoping light pole, galvanized, handrail mount, assembled with optional 25° top hat and T fitting

V65 H - G

Series

V65 V-Spring telescoping light pole

Mounting

B Base

W Wall

H Handrail stanchion

Stanchion mounting kits must be ordered separately. See table below for options.

Handrail mounting kits

MHK-RTG Tubular rail, galvanized

MHK-RTS Tubular rail, stainless

MHK-RAG Angled rail, galvanized

MHK-RAS Angled rail, stainless

MHK-RIG Incline rail, galvanized

MHK-RIS Incline rail, stainless

Material

G Galvanized steel

A Aluminum

S 316 stainless steel

Harsh environment cover

BLANK No cover

C Installed cover for locking collar

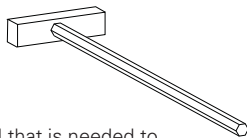

All that is needed to operate is ¼" allen wrench

Labor savings options

Minimum order quantity: 10 pieces

- JM5 - T57

Fitting*

T57 Form 7 – 1-½"

T58 Form 8 – 1-½"

T59SX77 Mark 9 (aluminum with ground screw) – 1-½"

T57SA Form 7 (aluminum) – 1-½"

*Contact factory for additional labor saving options

Top hat*

JM5 25° angled top hat

PM5 Straight top hat

*For Champ® series luminaires only

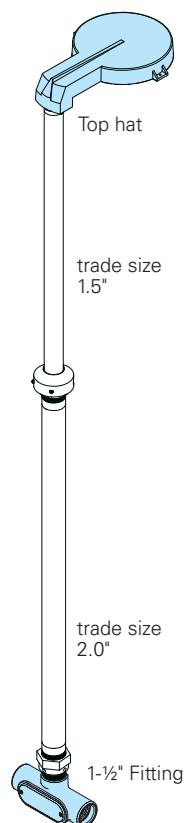

Accessories (ordered separately)

Harsh environment cover

EC65 Harsh environment cover for locking collar

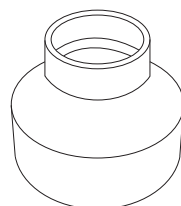

Pole removal

PRT Pole removal tool

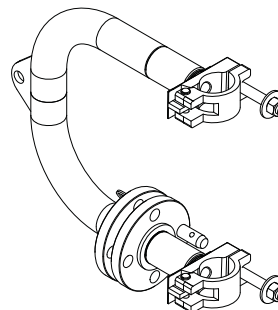

Luminaire mounts

Luminaire mounts - galvanized steel

LMB-FR240 2 ft. (610 mm) fluorescent clamp-on

LMB-FR440 4 ft. (1200 mm) fluorescent clamp-on

LMB-FRT40 3 ft. (920 mm) fluorescent clamp-on, cross arm

LMB-WP40 Multi-purpose bolt-on, vertical

LMB-MP40 Multi-purpose, bolt-on, horizontal

LMB-FL40 Floodlight bolt-on

JBP-G Junction box plate

Champ® only luminaire mounts - aluminum

JM5 25° angled top hat

PM5 Straight top hat

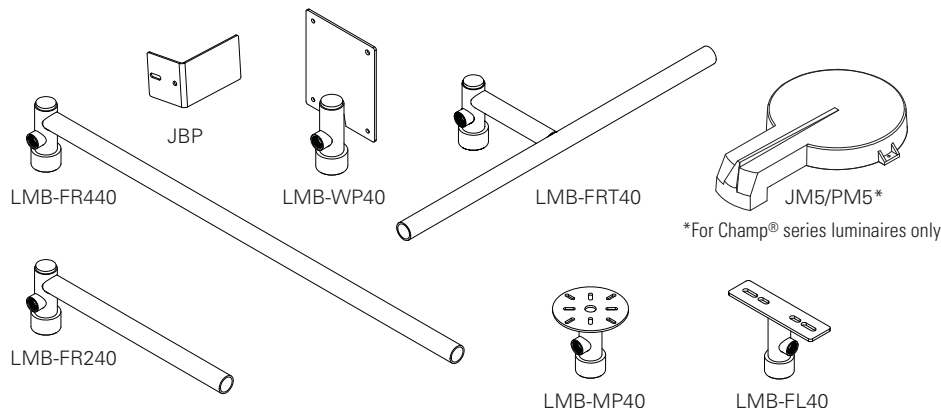

*For Champ® series luminaires only

Contact factory for aluminum or stainless options.

Installation options

Inclined rail mount

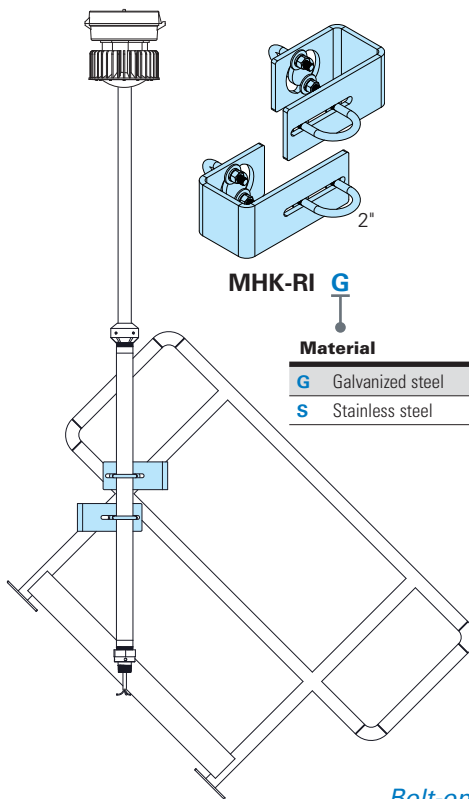

Universal rail mount - tubular rail

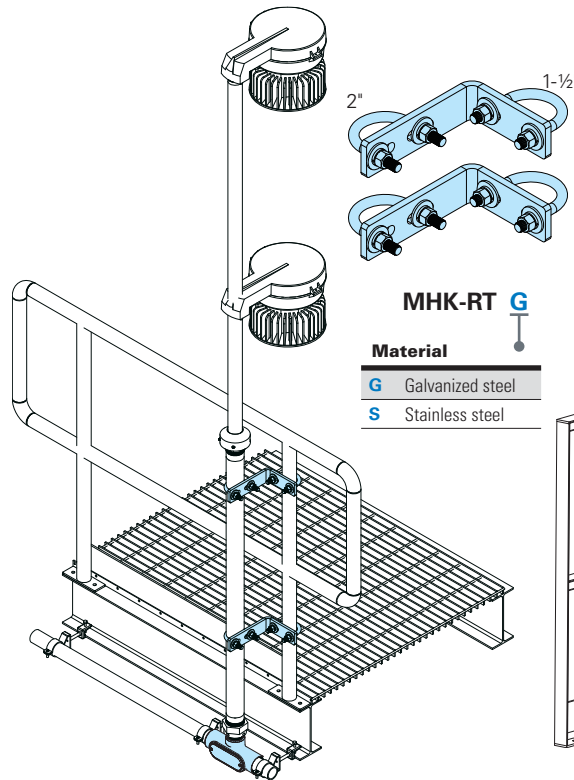

Universal rail mount - angular

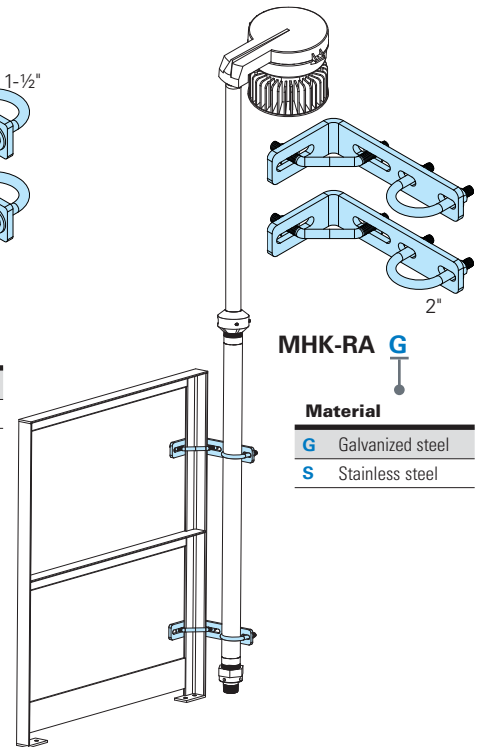

Bolt-on (weld-less) brackets provided as a complete kit

Base mount

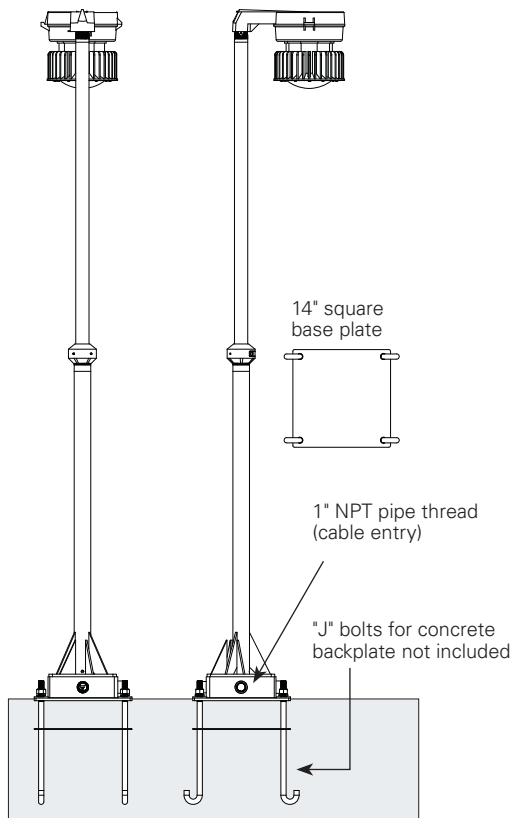

Column/wall mount

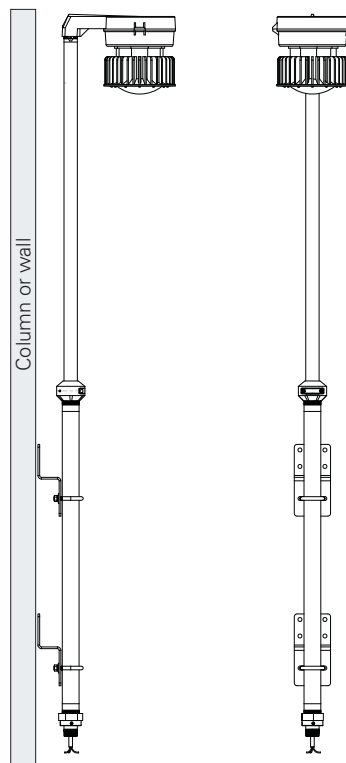

NOTE:

All mounting hardware for base and wall are included with pole.

Wall mount bracket included (MHK-WG)

For V-Spring dimensional drawings, please visit: www.crouse-hinds.com

Configure, view and download

Configure and select products down to the SKU level, view 2D drawings and 3D models and download the models in 100+ file formats.

www.crouse-hinds.com/cospec