

516 Parallel Cable Connector – LPC516

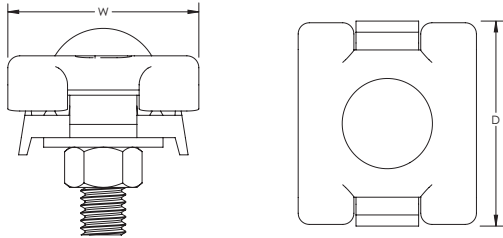

- Cable splice with positive single bolt tension grip on cable or wire
- For use with all full size cables on Class I/II structures
- Listed to UL® 96



Part Number	LPC516
Conductor Size, UL	Class 1 - Class 2 (4/0 Max)
Material	Copper
Finish	Bare
Depth (D)	46.74 mm
Width (W)	38.1 mm
Unit Weight	0.181 kg
Certifications	UL
Standard Packaging Quantity	1 pc
UPC	78285644856
EAN-13	8711893099126

UL, UR, cUL, cUR, cULus and cURus are registered certification marks of UL LLC.

WARNING

nVent products shall be installed and used only as indicated in nVent's product instruction sheets and training materials. Instruction sheets are available at www.erico.com and from your nVent customer service representative. Improper installation, misuse, misapplication or other failure to completely follow nVent's instructions and warnings may cause product malfunction, property damage, serious bodily injury and death and/or void your warranty.

© 2019 nVent All rights reserved

nVent, nVent CADDY, nVent ERICO, nVent ERIFLEX and nVent LENTON are owned by nVent or its global affiliates.

All other trademarks are the property of their respective owners. nVent reserves the right to change specifications without prior notice.